

# LCR Topper - Series

## Installation manual

### LCR-VL-Topper LCR-VR-Topper

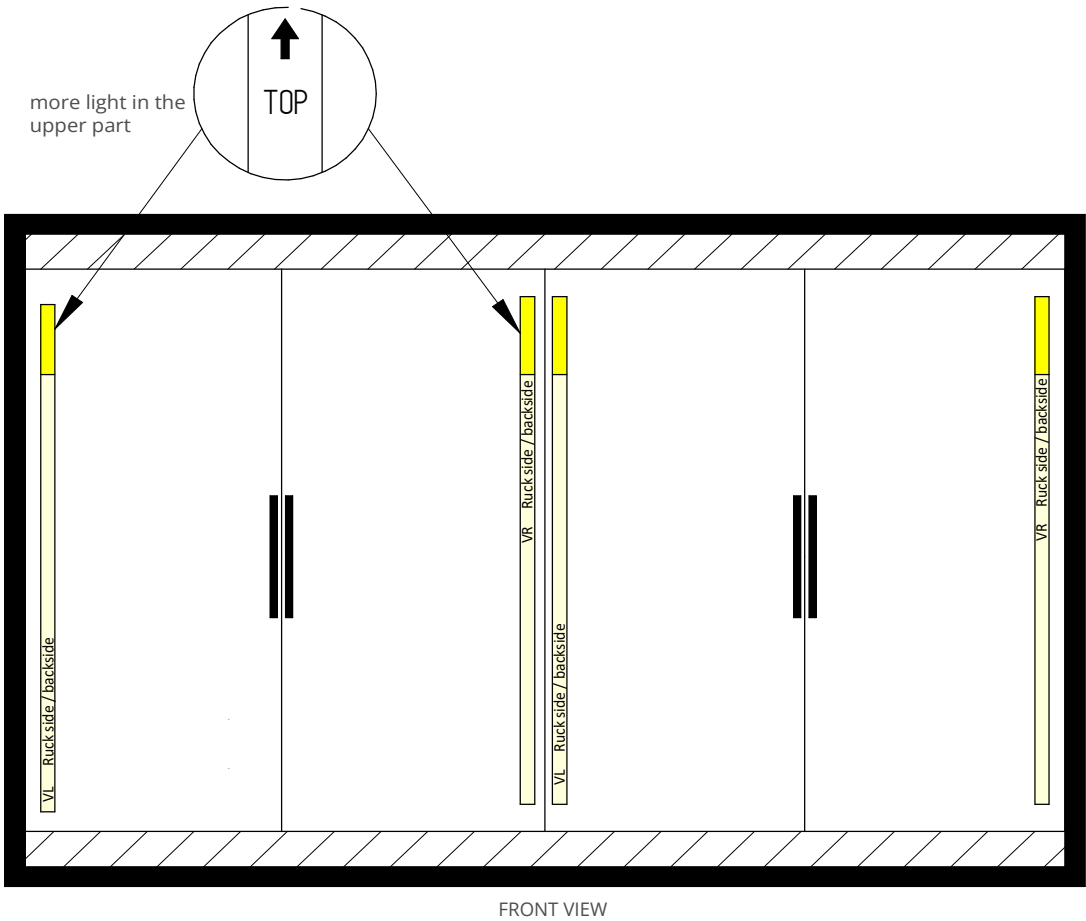

FRONT VIEW

LCR-VL-Topper (vertical left)	door jamb left
LCR-VR-Topper (vertical right)	door jamb right
LCR-VL-Topper+LCR-VR-Topper	door jamb central
Operating voltage	24 V DC
Type of luminaire	refrigeration lighting
Colour consistency	3 SDCM
Lifetime	L80 B10 50.000 h @ 10°C
Ambient temperature ta	-30°C to +10°C
Material	PC / aluminium

Dimensions in w mm

LCR-VL-Topper, LCR-VR-Topper



A **central vertical lighting** (LCR-VC-Topper) can be created by combining the following dedicated components:

- 1 piece LCR-VL-Topper
- 1 piece LCR-VR-Topper
- Double clip, Art. No.: 9100779
- Y-plug cable, Art. No.: 9100762



You will find the explanation of symbols at the end of the document under "Notes on luminaires"

# LCR Topper - Series

## Accessories

Art. No.: 9100763



LCR Connection cable with plug male grey 4,0m

Art. No.: 9100759

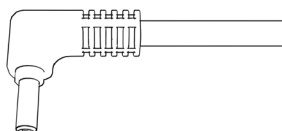

LCR Connection cable with angled plug grey 4,0m

Art. No.: 9100762

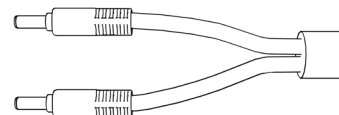

LCR Connection cable Y-plug, grey 4,0m for LCR-VC

Art. No.: 9100760

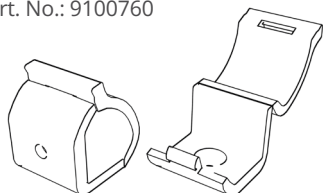

LCR Clip transparent, 2 pcs set

Art. No.: 9100779

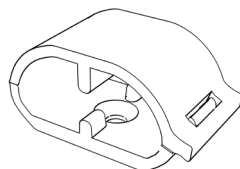

LCR Clip transparent, 2 pcs set

Art. No.: 9100761

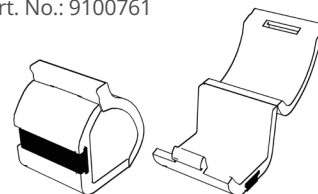

LCR Clip transparent with magnet, 2 pcs set

Art. No.: 9100767

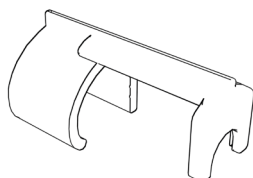

LCR Strip lock transparent

Art. No.: 9100769



LCR Hollow plug end cap, grey

# LCR Topper - Series

## Installation

Screw Recommendation: Countersunk head with drill point

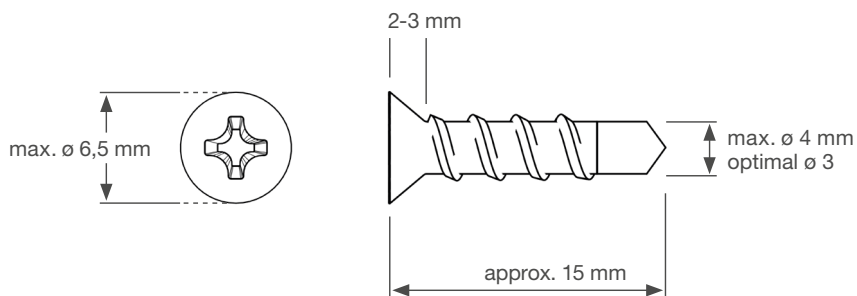

### A. Mounting with screw clip: LCR-VL-Topper, LCR-VR-Topper

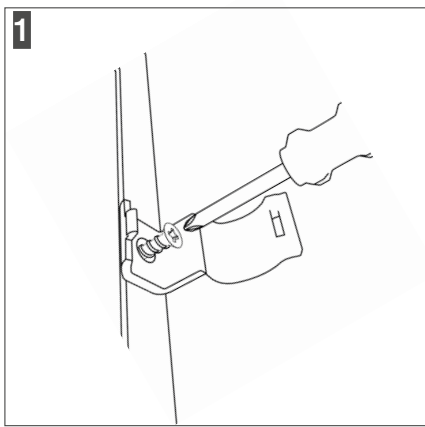

1. Before using the recommended screws, make sure that no cables or wires in the cooling unit can be damaged.

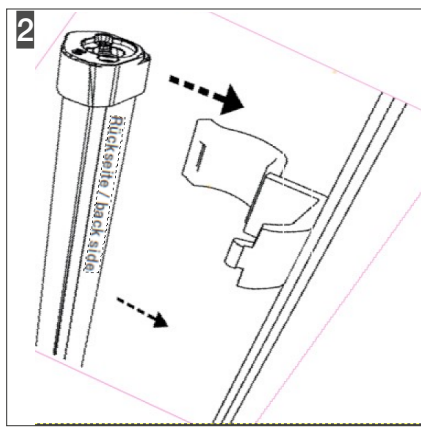

2. The correct positioning of the strips is supported by the mounting symbols: **Rückseite / back side** are used to support the correct positioning of the strips. The drill hole or magnet must always be on the surface of the mounting symbols.

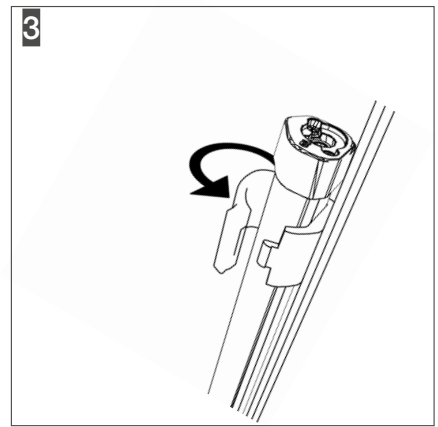

3. Close the clip. If the clip does not close comfortably, please check whether the bars have been inserted correctly as described in Fig. 2.

### B. Mounting with Double Clip: Central Vertical Lighting (LCR-VC-Topper = LCR-VL-Topper + LCR-VR-Topper)

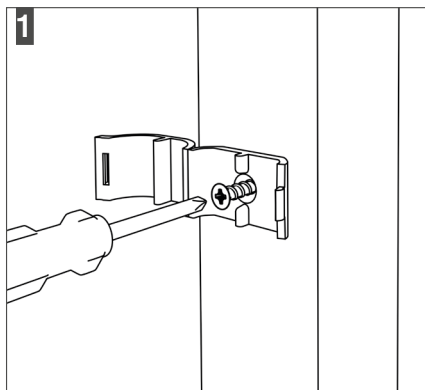

1. Before using the recommended screws, make sure that no cables or wires in the cooling unit can be damaged.

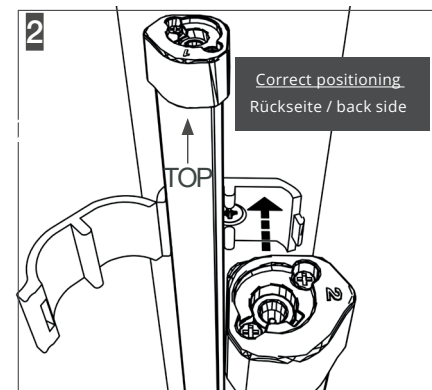

2. During the installation of the LCR-VC, make sure that the mounting symbols: **Rückseite / back side** are facing the door jamb. The **TOP** marking indicates the upper part of the luminaire – install the luminaire with the arrow pointing upwards.

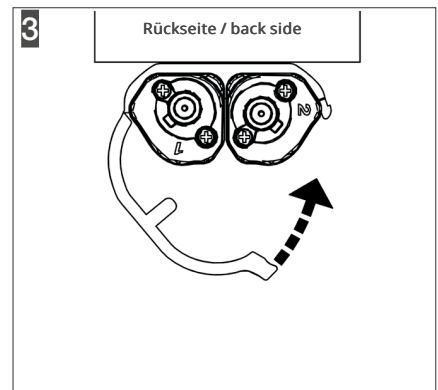

3. Close the double clip. If the clip does not close comfortably, please check whether the bars have been inserted correctly as described in Fig. 2.

# LCR Topper - Series

## Installation

### C. Strip lock

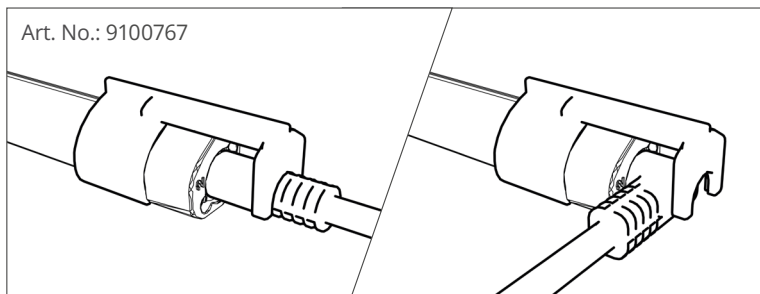

The Strip lock preventing the plug from slipping out is designed for all LCR types. One Strip lock clip is required per plug.

In devices using propane (R290), the use of the locking clip to prevent the plug from slipping out is mandatory!

### D. Hollow plug

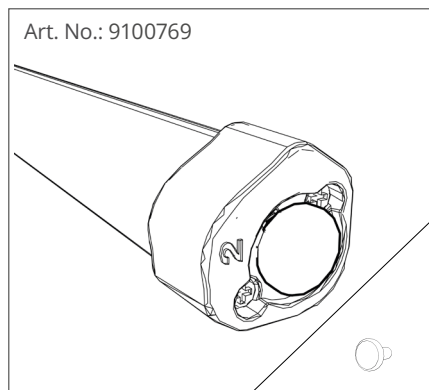

The Hollow plug is required to ensure the declared IP protection on the non-powered side.

**If necessary, move the cover to the other side of the luminaire!**

# LCR-Series

## Notes on luminaires



EN Attention. Electrostatic sensitive device.

The LCR product series is used for the illumination of refrigerators. The installation of the light may only be carried out by an approved electrician.

Only certified LED drivers according to EN 61347-2-13:2014+A1:2017 may be used.

If the LED driver has a lower protection class (e.g. IP20) than the lamp (IP65), please make sure that the power supplies are installed on the refrigerated counters according to the standards.

The light source of this lamp is not exchangeable! When the light source has reached the end of its life, the entire lamp must be replaced. Before electrical installation, maintenance or cleaning, the circuit must be disconnected from the mains and secured against being switched on again.

To clean the lamp, please use a soft, dry cloth without detergent. To remove stubborn stains, use a slightly damp cloth if necessary. Never use abrasive or corrosive materials.

Note on screws: The screws shown are recommendations. Before installation, please make sure that the recommended sizes and lengths can be fitted in the respective installation situation without causing damage to the refrigeration units or cables.



The IP65 marking is an indication of the degree of protection of an electrical device 6: Protection against contact, protection against dust ingress 5: Protection against water jets from any direction.



Protection class III luminaires.



By CE marking, the manufacturer declares that the product complies with the applicable requirements specified in the harmonization legislation of the European Union.



This symbol indicates that the marked device is not to be disposed of in normal household waste, but must be collected separately.



For use as refrigerator lighting.

24 V  24 Volts DC.

ta: Maximum permissible ambient temperature -30°C to +10°C.